

REDEVELOPMENT PROJECT PROFILE

150 MAIN STREET APARTMENTS



*THIS IMAGE IS A CONCEPTUAL RENDERING
THAT IS SUBJECT TO CHANGE

VISION

DOWNTOWN RESIDENTIAL TOWER
WITH MIDBLOCK CONNECTION +
INNER-BLOCK PARK

This mixed-use tower project will feature 400 residential units, with 40 being rented as affordable for residents making roughly 60% to 80% of the City's average income.

The project will also create a new midblock walkway on Main Street, and feature public open space and art. Main Street will be activated through the incorporation of publicly-accessible open space, pedestrian connections, ground-floor retail, and dining options.

Decorative elements from the property's former theater structure have been documented and archived and can be accessed here:
<https://pta.lib.utah.edu/>

DETAILS

ADDRESS

150 S. Main Street

PROPERTY SIZE

.89 acres

RDA PROJECT AREA

Central Business District

RDA INVESTMENT TO DATE

\$5 million property write-down

ESTIMATED TOTAL PROJECT COST

\$100 million

DEVELOPMENT PARTNERS

Hines

HOUSING UNITS

360 market-rate;
40 affordable (60-80% AMI)

GROUND-FLOOR RETAIL

~8,400 square feet

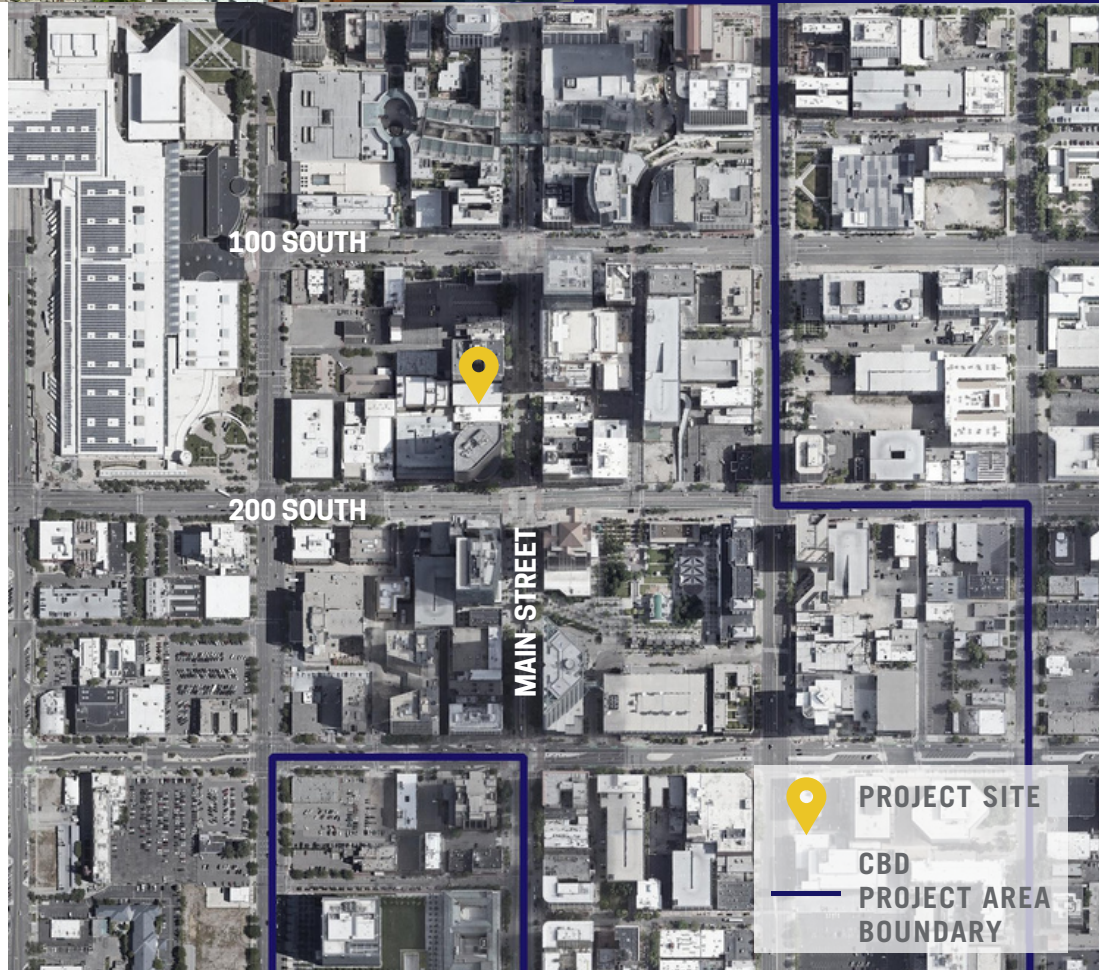

MILESTONES

- ✓ PROPERTY ACQUISITION / 2010
- ✓ SITE PRESERVATION FEASIBILITY + USER GROUPS RESEARCH / 2010-2016
- ✓ ADJACENT PROPERTY OWNER NEGOTIATIONS / 2015-2019
- ✓ BOARD SALES AUTHORIZATION / Q4 2019
- ✓ THEATER DOCUMENTATION + PRESERVATION / Q1 2020 - Q4 2020
- ✓ FINALIZE DESIGN CONCEPT / Q1 2020 - Q4 2020
- ✓ PROPERTY SALE / Q4 2021
- ✓ DEMOLITION / Q2 2022
- GROUNDBREAKING
- CONSTRUCTION

Building Section A

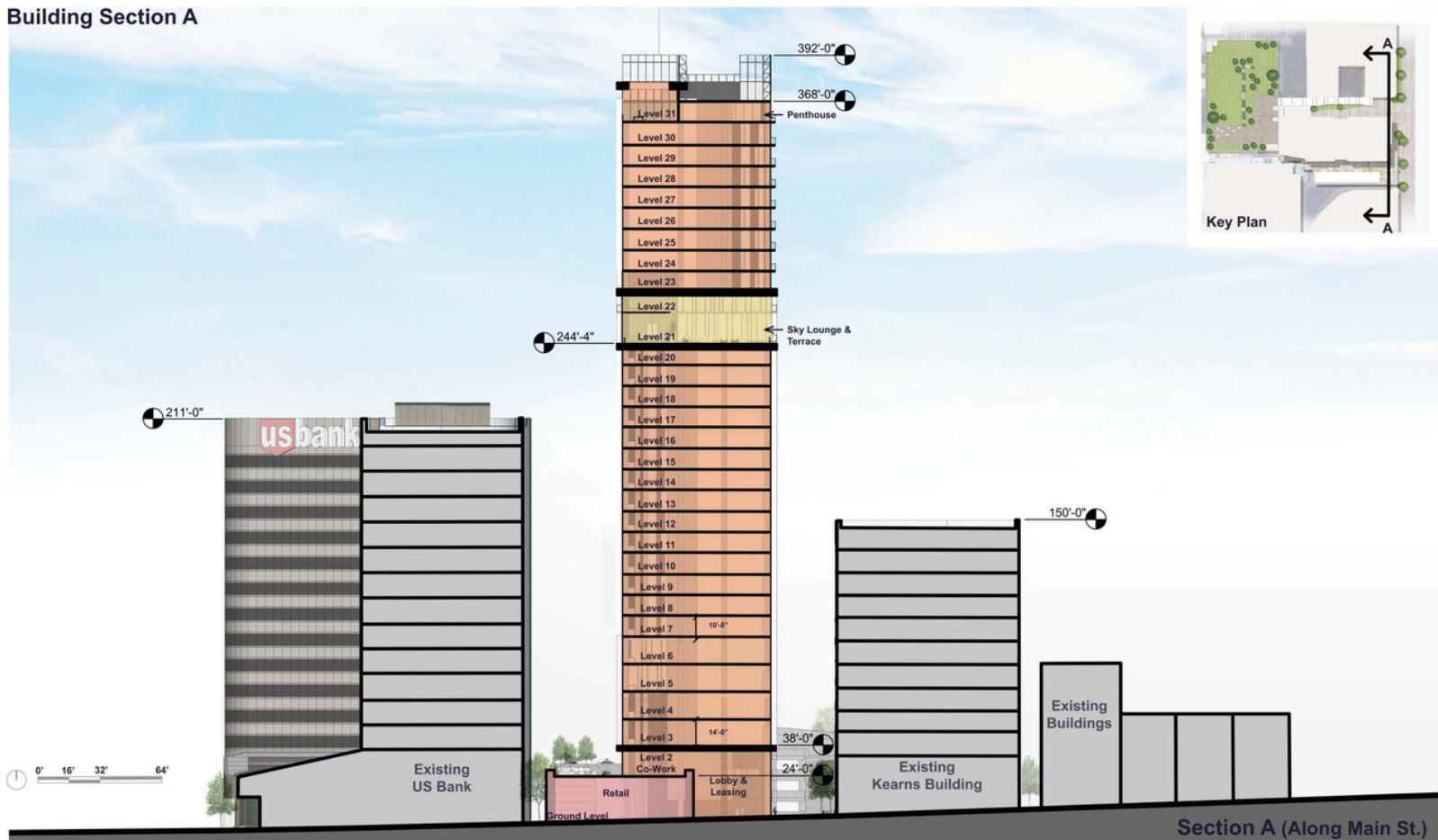

Section A (Along Main St.)



SLCRDA

PROJECT CONTACT

Danny Walz

801.535.7240

danny.walz@slcgov.com